



NOTICE OF PESTICIDE APPLICATION

10/4/24

Date of Application-

Location- Ladera - See Map

Product and Manufacturer Name-Attrimec -Gordon Corporation

Safety Precautions, Active Ingredients, and US EPA Number:

EPA Reg. No.: 2217-776

Active Ingredients: Dikegulac-sodium

Precautionary Statement: Keep out of reach of children. CAUTION: Causes moderate eye irritation. Avoid contact with skin, eyes, or clothing.

Reason for Application: Plant Growth Regulator- targeting specific high growth rate plants

Attached is the Label and MSDS Sheet

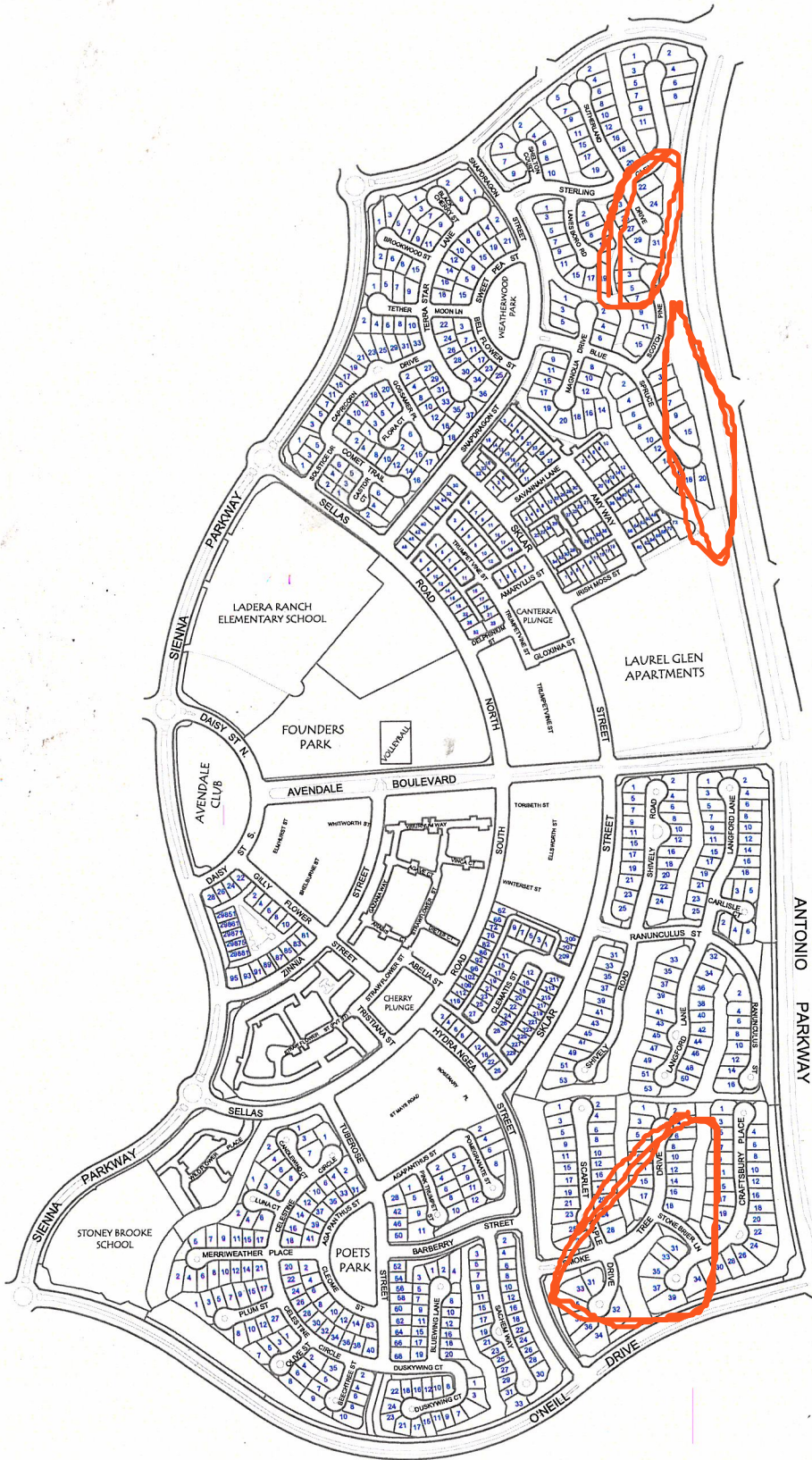



LADERA RANCH

 AVENDALE PHASE 3



O'CONNELL

 LANDSCAPE MAINTENANCE